



1. Product Name

Massage Chair

2. Product Code

20186

3. Colour

Black, brown or cream

4. Brief Description

Attractive, reclining, luxury chair with hand-held controller. With massage, heat and timer functions.

5. Contents

- 1 x chair with power adapter and controller

6. Snoezelen® Stimulations

- Touch

7. Best Use

Use indoors, on a flat, stable surface.

8. Compatible ROMPA® Products

Not applicable

9. Starting Up

- Connect the back of the chair into the seat.
- Connect the handset to the back of the seat.
- Connect the power adapter and plug in.

10. Detailed Description

Attractive, reclining, luxury chair with hand-held controller. With massage, heat and timer functions. Black, brown and cream – please specify colour required when ordering. Maximum weight supported: 136kg. Model may vary according to availability.

Massage Chair Functions

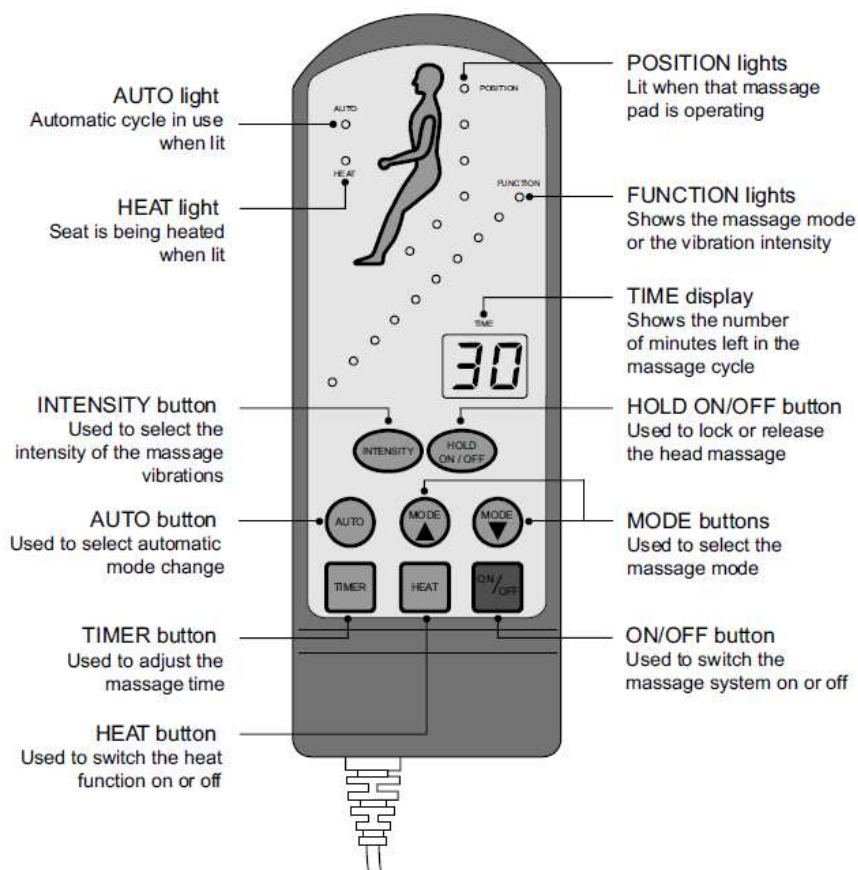

- Press the ON/OFF button to switch the massage unit on. The massage unit will start with a 30 minute massage programme which automatically alters the massage mode every minute. Press the ON/OFF button again to switch off the unit.
- Press the HEAT button to switch the heat function on. The HEAT light will be lit when this function is on. Press the HEAT button again to switch the heat function off.
- To adjust the time which the massage unit will run for (shown on the TIME display) press the TIMER button. The time will then increase up to a maximum of 99 minutes, after which pressing the TIMER button will reset the time to 1 minute.
- Press the AUTO button to switch the automatic mode cycle function off, which stops the unit from changing massage mode every minute. Press the AUTO button to switch on the automatic mode cycle function. The AUTO light is lit when the automatic mode cycle function is on.
- Press one of the MODE buttons to move up or move down a massage mode. The current massage mode is shown by one of the ten FUNCTION lights being illuminated.
- Press the INTENSITY button to increase the intensity of the massage vibrations. After pressing the button, the new intensity will be shown momentarily by illuminating a number of the FUNCTION lights (the number lit depends on the intensity. Once the intensity is at maximum, pressing the button again will reset the intensity to its lowest level.
- Press the HOLD button to lock the head massage in its current state. Press the button again to release the lock.

11. Safety

- Always supervise the use of this product
- For use indoors, in dry environments.
- Use only the power adapter supplied.
- Do not exceed the maximum weight supported: 136kg.

Important Safety Information



Please read all of these instructions fully before assembly or operation.

- Unpack and check that you have all of the parts and attachments shown.
- To avoid risk of suffocation to children or animals, dispose of the plastic bags correctly.
- Remove all packing materials and dispose of correctly.
- Assembly is best carried out by 2 people.
- For indoor household use only.
- Ensure that only Drive parts are used on the armchair. Periodically visually inspect the handset and power cord for signs of wear, chafing or cracks.
- When reclining the armchair, ensure that you will not collide with anybody behind you.
- Carelessness Causes Fire. Caution should be taken to avoid fire. Please ensure that all cigarettes and matches are properly extinguished. Please be careful of other fire hazards such as electric and gas fires, etc nearby.
- The weight limit on the armchair is 21 stone (136 kg). Please ensure that only one person uses the massage chair at any one time.
- Do not use the massage chair in dusty, humid or damp environments as this could affect the electrical and mechanical parts of the armchair. The armchair may also be sensitive to temperature changes. If possible, try to gradually change the environment temperature. If this is not possible, do not use the armchair for the first hour after the temperature change.
- Be careful with the cables on the massage chair. When plugging/unplugging parts, always grip the connectors (not the cables). Ensure that cables are free, not taut or wound around, and that there is no risk of cables being caught, snagged or chafed.
- Keep your body relaxed during the massage. If you require a more gentle massage place a blanket or towel on the chair behind you.
- Please consult your doctor before using the massage chair if you are convalescing, pregnant or have malignant tumour(s), or high fever.
- If you suffer from any abnormal and/or serious pains when using the massage chair, switch off the massage function and consult your doctor.
- If any of the following occur, switch off the massage chair and remove the power supply from the mains:
 - The massage chair does not work or has got wet.
 - The fabric of the massage chair is damaged and parts are exposed.
- This appliance is not intended for use by persons (including children) with reduced physical, sensory or mental capabilities, or lack of experience and knowledge, unless they have been given supervision or instructions concerning use of the appliance by a person responsible for their safety. Children should be supervised to ensure that they do not play with the appliance.

12. Technical Specification

Size: 82W x 94D x 88cmH; seat 39W x 54D x 50cmH
Weight: Approx 44kg
Input: 100 – 240V 50/60Hz 0.4A
Output: 12V $\overline{=}$ 1.2A 18W
CE: Meets the requirements of RoHS, CE, TUV and BS EN 61558-2-6 and 61558-2-17
Adapter: double isolated
Material: Upholstered in PU

13. Installation

An easy manual recline mechanism is located at the bottom, on the side of the chair.

Chair Assembly Instructions

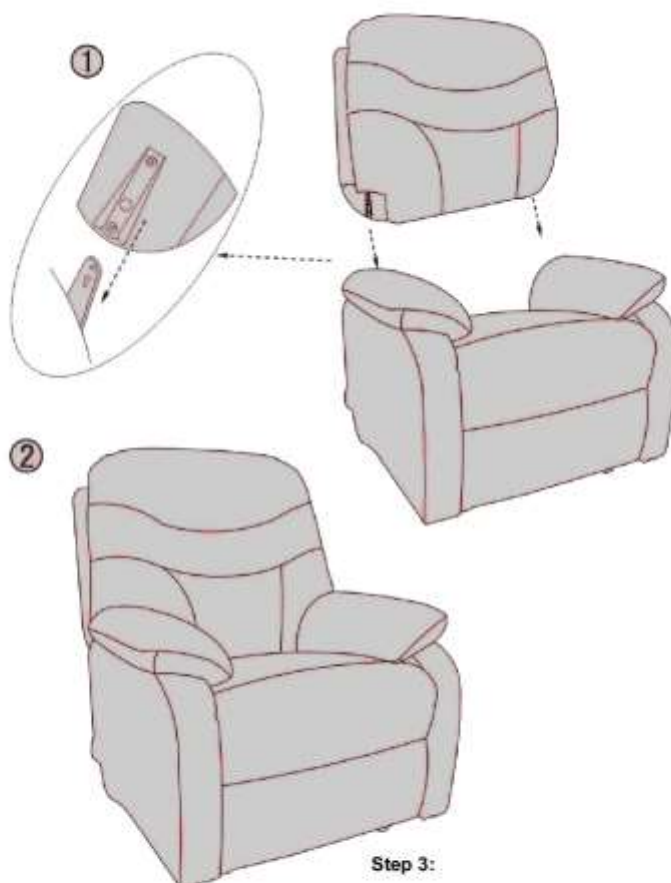

Step 1:

Line up the backrest with the receiver brackets on the chair (as shown in the diagram)

Step 2:

Press down on both sides of the backrest until it locks in position, which can be heard by an audible click.

Connect the white connector on the backrest to the white connector on the base unit.

Step 3:

Connect the massager handset to the large black connector on the base unit.

Connect the power supply in to the small black DC connector on the base unit.

Step 4:

Plug the power supply and the mains plug in to the mains socket and switch both plugs on.

14. Care and Maintenance

Care and Maintenance

Storage:

- Keep the massage chair dry and clean. Use a dust sheet to protect the massage chair if it will not be used for a long period.
- Do not expose the chair to strong sunlight or high temperatures, as this could cause the fabric to fade.
- When not in use, switch the massage unit off and disconnect from the mains.
- Do not put any heavy articles on to the armrests or footstool as this could damage the armchair and/or cause it to become unstable. Do not sit or stand on the armrests or footstool.

Cleaning:

- Do not rub the surface of the chair with hard or coarse objects.
- The wooden parts of the chair may be cleaned with a duster or dry cloth. Polish should not be used as this can cause abrasion of the wood.
- Use a damp cloth with mild detergent to clean the fabric upholstery and steel frame. Then wipe with a dry cloth. Do not use detergents containing solvent as this could damage the fabric.
- Only use a dry cloth to wipe the handset.

15. Troubleshooting

In the unlikely event of product failure, please check the following:

Symptom	Cause	Possible solution
Noisy operation	Noise occurs during use. Noise from pulsator, especially when no one is sat in the chair.	These are normal sounds during operation. Possibly from friction between the massager and the upholstery.
The chair will not switch on	No power. Loose or missing connection.	Check the power is on. Check the PSU is fully in the mains socket. Check the handset is connected.
Footstool	Footstool will not vibrate.	Check footstool is connected to the chair.

Further copies of these instructions can be downloaded at www.rompa.com

We hope you find our instructions invaluable. If you have any suggestions for improving them further your comments will be greatly received – please contact us at

producthelp@rompa.com