



1. Product Name

Tom

2. Product Code

21863

3. Colour

As shown

4. Brief Description

A lovable baby boy to care for and cuddle.

5. Contents

- 1 x dressed Tom

6. Snoezelen® Stimulations

- Sight
- Touch

7. Best Use

Tom can be enjoyed by children and by adults with learning difficulties for recreational play, imaginative play and for role-play. Tom has particular value for older adults with Dementia, as he is comforting and can provide a sense of purpose, role, identity and usefulness. In an era when many women have a profession, we should not forget that for many older ladies, their career was that of mother, housewife and homemaker. Furthermore, for someone who is looked after the majority of the time, it can be alerting, stimulating and empowering to experience role-reversal, and become the care-giver. Tom can also help awaken memories of parenthood and happy family moments, as well as providing a sense of attachment. Tom can have real symbolic significance, and because of his realistic attention to detail, he should not be regarded simply as a doll or toy.

Suggestions for introducing Tom to an older person with Dementia

- When the older person is sat comfortably, sit in a chair alongside the person, whilst holding Tom. Gradually introduce the older person to Tom, giving the infant a name. Talk about the baby's pretty eyes, beautiful hair, face, cute nose and so on, just as you might comment on the features you like of a real baby. After a little while, invite the older person to hold the baby. Take your time, and watch the responses of the older person so as not to rush them into holding the baby. Make sure it is their choice to hold the baby – it may not be the same time that you show the baby for the first time, so be patient.
- Always maintain the illusion that the baby is real. It can cause distress to the older person you are caring for – and others – if you later discard the baby amongst other resources or forgetfully carry the baby by its feet.
- Choose your time carefully and be conscious of other people around you. Be wary that others may realise the baby is not real and could make negative comments which may undermine your efforts.
- Involve the family and friends of the older person. Make sure they understand the value of the baby, and that they realise that you are seeking to provide comfort. Explain that use of the baby is not condescending or patronising – it is intended to stimulate pleasant memories and provide a sense of purpose. Once the family is on board with your intentions, invite them to provide information that gives valuable insight about the person you are looking after. Perhaps the person has particularly strong memories of a certain activity with the baby, e.g. walking with the baby in a pram, or of a particular gesture a baby made.
- Be prepared to expand on the use of the baby if the person you are caring for finds him particularly comforting. Provide a crib, pram or blankets if the person wants the baby to sleep in their room. Purchase additional clothes for the baby if the person particularly likes to dress the baby. Seat the baby next to the person at mealtimes if this is reassuring.
- Make the baby seem as realistic as possible, by using the Heart to provide gentle vibrations (a rhythm of approximately 60 beats a minute) and subtle sounds. Many of us associate a particular smell with babies – consider washing the clothes in baby shampoo or baby body wash to replicate the aroma of a real baby. If a particular aroma (e.g. lavender) is particularly soothing for an individual, place a few drops of

essential oil (available from ROMPA®) onto a ball of cotton wool and place this inside the pouch at the side of the baby.

8. Compatible ROMPA® Products

29327 – Heart

9. Starting Up

- Introduce the baby with care, as though the baby were real and your own infant.

10. Detailed Description

A lovable baby boy to care for and cuddle. With his own character and cheerful expression, he is comforting and can provide a sense of purpose and commitment to an older person with Dementia or to an adult with learning difficulties. For children, Tom can be stimulating and encourage imaginative play. Because of his realistic size, weight and appearance he can awaken emotions and memories. Tom can be dressed and used with the Heart or with an aroma placed in cotton wool in the pocket in his side for added sensory input. Washable.

11. Safety

- Always supervise the use of this product.

12. Technical Specification

Size: Size: 50cmH

13. Installation

Not applicable

14. Care and Maintenance

- Hand-wash at 30°C. Allow to air-dry naturally. Avoid harsh, abrasive cleaning products and products that contain bleach. Remove the clothes before washing.
- Handle with care

15. Troubleshooting

Problem: The Heart will not fit into the pocket

- The Heart is a tight fit in the pocket, especially when Tom is new and his stuffing is still very firm because the pocket is scrunched up by the stuffing process. Gently persist with pushing the Heart into the pocket.

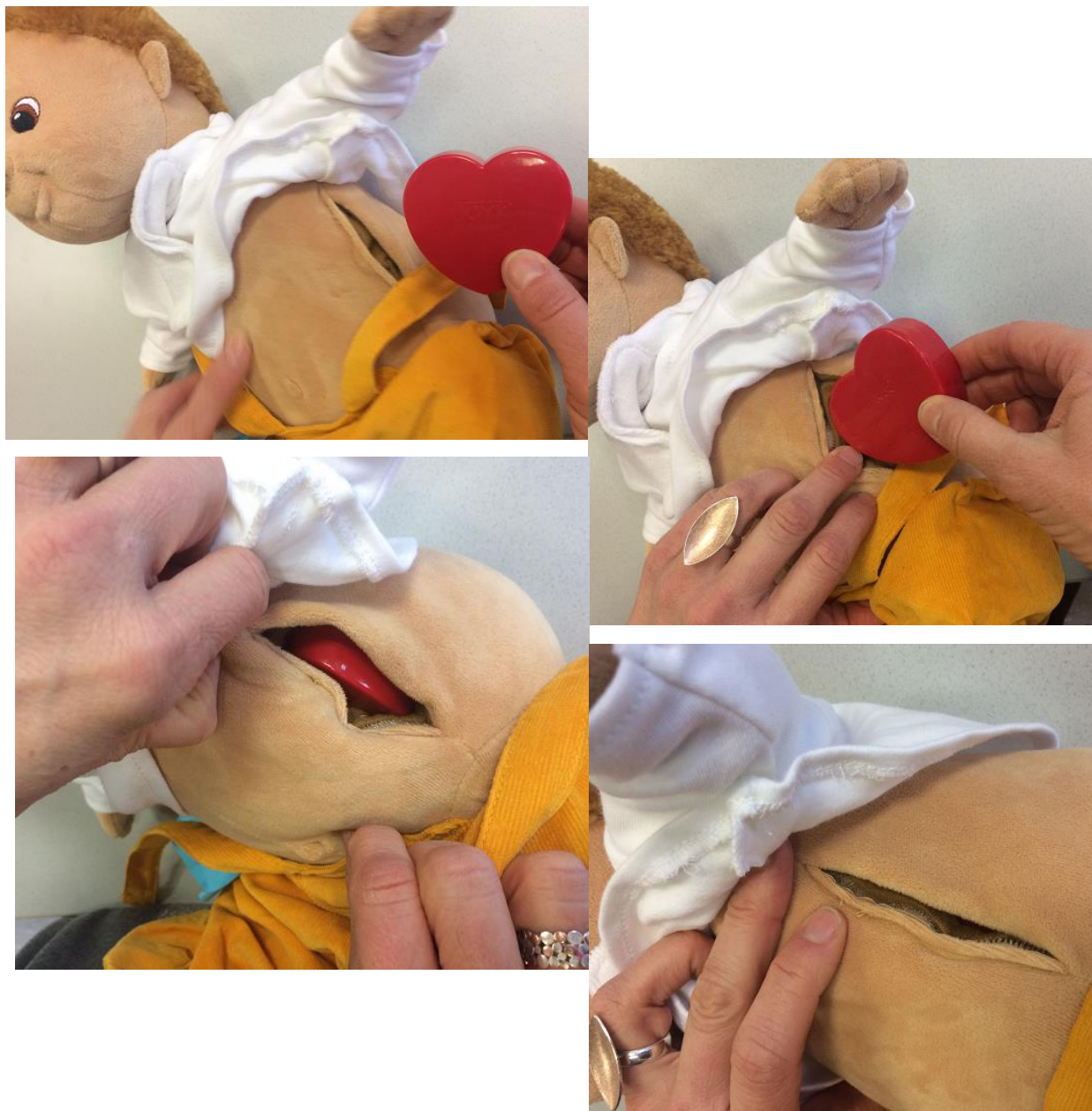

Further copies of these instructions can be downloaded at www.rompa.com

We hope you find our instructions invaluable. If you have any suggestions for improving them further your comments will be greatly received – please contact us at producthelp@rompa.com